



## Alfa Laval LKFL In-line Sight Glass

Accurate gauge glass for visual inspection of tanks

### Introduction

The Alfa Laval LKFL In-line Sight Glass is an accurate, tight-fitting gauge glass in acid-resistant steel. It permits direct distortion-free visual inspection of process conditions, products, liquid levels and cleaning in a pipeline.

### Application

The LKFL In-line Sight Glass is a rigid, hygienic sight glass housed in acid-resistant steel. It is designed for visual inspection of a product in a hygienic pipeline across the food, beverage, pharmaceutical and many other industries.

### Benefits

- Reliably clear viewing quality
- Provide clear, continuous and unobstructed visibility of processes
- Sight glass construction and range

### Standard design

The Alfa Laval LKFL In-line Sight Glass consists of a stainless steel semi-bright tube with two screw connections for the borosilicate glass discs. The connections are placed opposite each other to enable positioning of the glass very close to the internal wall of the tube to facilitate cleaning.

The glass discs are internally sealed with EPDM rubber seals and, from the outside, pressed against the seal by a nut via a spacer.

An optional halogen light source, which is fitted onto one of the sockets, is available. The halogen light source consists of two stainless steel tubes assembled with a clamp.

The standard LKFL connections are welding ends. Upon request, the LKFL In-Line Sight Glass is also available with male part connections.



## TECHNICAL DATA

### Pressure

|                        |                   |
|------------------------|-------------------|
| Max. product pressure: | 2000 kPa (20 bar) |
| Min. product pressure: | Full vacuum       |
| Max. pressure shock:   | 3000 kPa (30 bar) |

### Temperature

|                    |                         |
|--------------------|-------------------------|
| Temperature range: | -10°C to +140°C. (EPDM) |
|--------------------|-------------------------|

|                       |                          |
|-----------------------|--------------------------|
| Max. thermal shock:   | D t 120°C (140°C P 20°C) |
| Bulb, halogen:        | 24 V DC, 24 Watt, G4     |
| Bulb socket standard: | G4, max. 35 V DC         |
| Cable:                | Max. OD 10.5 mm          |
| Reflector:            | OD 50 mm                 |

## PHYSICAL DATA

### Materials

|                       |                                |
|-----------------------|--------------------------------|
| Product wetted parts: | Acid-resistant steel AISI 316L |
| Other steel parts:    | Stainless steel AISI 304       |
| Glass:                | Borosilicate glass             |
| Seals:                | EPDM rubber                    |
| Finish:               | Semi bright                    |

### Sizes

38 mm (1 1/2"), 51 mm (2"), 63.5 mm (2 1/2"), 76.1 mm (3") and 101.6 mm (4").

### Connections

Type LKFL sight glass is available with welding ends or with male parts according to optional standards, e.g. ISO, DS, SMS, DIN, BS, or with clamp liners.

## Dimensions

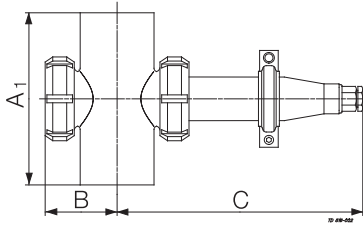

| Size (mm)     | 1½" | 2"  | 2½" | 3"  | 4"  |
|---------------|-----|-----|-----|-----|-----|
| A1            | 103 | 152 | 152 | 205 | 205 |
| B             | 50  | 66  | 64  | 73  | 91  |
| C             | 179 | 194 | 191 | 199 | 244 |
| ID            | 20  | 34  | 34  | 44  | 60  |
| Weight (kg)   |     |     |     |     |     |
| Without light | 0.8 | 1.9 | 1.2 | 1.7 | 3.3 |
| With light    | 1.3 | 2.5 | 1.8 | 2.3 | 3.9 |

## Overall length

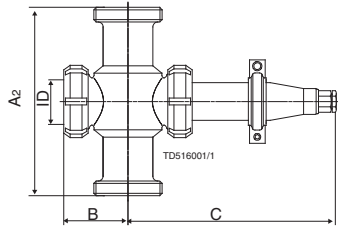

| Size (mm)        | 1½" | 2"  | 2½" | 3"  | 4"  |
|------------------|-----|-----|-----|-----|-----|
| SMS              | 142 | 192 | 200 | 252 | 274 |
| DS               | 142 | 192 | 200 | 252 | 252 |
| ISO clamp        | 128 | 177 | 177 | 229 | 236 |
| IDF for ISO tube | 145 | 195 | 195 | 247 | 247 |
| IDF for SWG tube | 145 | 195 | 195 | 247 | 264 |
| BS               | 146 | 196 | 196 | 248 | 258 |
| DIN              | 146 | 196 | 202 | 264 | 264 |

## Options

### Material grades

A. Seals of Nitril (NBR) or flourinated rubber (FPM).

### Ordering

Please state the following when ordering:

- Size.
- Connections. If male parts, please state standard.

Alfa Laval reserves the right to change specifications without prior notification.

---

**How to contact Alfa Laval**

Contact details for all countries  
are continually updated on our website.  
Please visit [www.alfalaval.com](http://www.alfalaval.com) to  
access the information direct.