

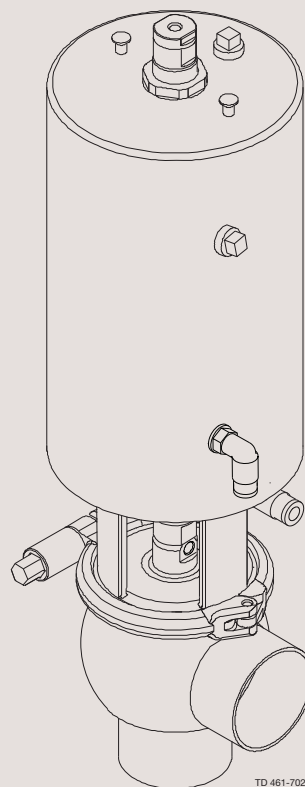

Instruction Manual

Unique Single Seat Valve - Two Step

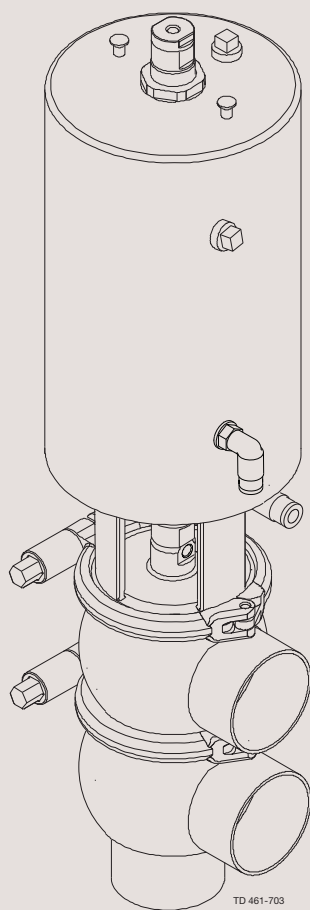

ESE00505-EN10

2020-02

Original manual



www.sks-online.com

The information herein is correct at the time of issue but may be subject to change without prior notice

1. EC Declaration of Conformity	4
2. Safety	5
2.1. Important information	5
2.2. Warning signs	6
2.3. Safety precautions	7
3. Installation	9
3.1. Unpacking/delivery	9
3.2. General installation	10
3.3. Welding	12
3.4. Recycling information	13
4. Operation	14
4.1. Description af valve function	14
4.2. Operation	17
4.3. Troubleshooting	19
4.4. Recommended cleaning	20
5. Maintenance	22
5.1. General maintenance	22
5.2. Dismantling the valve	24
5.3. Plug seal replacement	25
5.4. Valve assembly	28
5.5. Actuator types	29
5.6. Actuator bushing replacement	30
5.7. Dismantling of (NC) maintainable actuator	34
5.8. Dismantling of change-over (NO) maintainable actuator	36
5.9. Assembly of maintainable actuator	37
5.10. Changing pneumatic movement on fully maintainable actuator (NC/NO)	38
6. Technical data	40
6.1. Technical data	40
7. Parts list and service kits	42
7.1. Drawing	42
7.2. Unique Single Seat Valve - Two Step 38-101.6mm - shut-off valve	43
7.3. Unique Single Seat Valve - Two Step 38-101,6mm - change-over valve	45
7.4. Mounting tool - Unique SSV - Two Step maintainable actuator	47

1 EC Declaration of Conformity

Revision of Declaration of Conformity 2018-04-01

The Designated Company

Alfa Laval Kolding A/S

Company Name

Albuen 31, DK-6000 Kolding, Denmark

Address

+45 79 32 22 00

Phone No.

hereby declares that

Valve

Designation

Unique SSV PN10

Type

From serial number 1000000 to 70000000000

is in conformity with the following directive with amendments:

- Machinery Directive 2006/42/EC
- Pressure Equipment Directive 2014/68/EU category 1 and subjected to assessment procedure Module A. May only be used for fluids in Group 2

The person authorised to compile the technical file is the signer of this document

Global Product Quality Manager
Pumps, Valves, Fittings and Tank Equipment

Title

Lars Kruse Andersen

Name

Kolding

Place

2018-04-01

Date

Signature



*Unsafe practices and other important information are emphasised in this manual.
Warnings are emphasised by means of special signs.*

2.1 Important information

Always read the manual before using the valve!

WARNING

Indicates that special procedures must be followed to avoid serious personal injury.

CAUTION

Indicates that special procedures must be followed to avoid damage to the valve.

NOTE



Indicates important information to simplify or clarify procedures.

Different actuator types for the SSV valve

In June 2016 the below change was implemented and the “removable yoke with bolts” version is thereby phased out and replaced by the “yoke without bolts” version.

NOTE

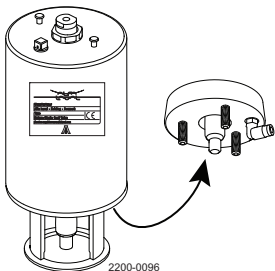
It is important to check for warnings marked on the actuator when servicing an actuator - see below table.

Actuator type	Fully maintainable actuator Spring cage and can be opened	Fully maintainable actuator Spring cage and can be opened
		
Yoke type	“Removable yoke with bolts”. If the yoke with bolts is damaged it has to be replaced by the “yoke without bolts”	“Yoke without bolts”
Service	Yes	Yes
Marked with warnings	No	No
Year of production	From 2006 to June 2016	From June 2016

2 Safety

*Unsafe practices and other important information are emphasised in this manual.
Warnings are emphasised by means of special signs.*

2.2 Warning signs

General warning



Caustic agents



All warnings in the manual are summarised on this page.

Pay special attention to this instructions below so that severe personal injury and/or damage to the valve are avoided.

2.3 Safety precautions

Actuators

If support air is utilised:



- Shock in the actuator must **NEVER** occur
- Support air on high pressure actuator versions is **NOT** allowed

To prevent shock in the actuator and to prevent exceeding 10 bar product pressure, Alfa Laval recommends **NOT** to exceed 3 bar support air on the spring side in all the Unique SSV actuators.

If support air is connected always use the 3 bar air relief fittings = 9611995903.
Using the 3 bar air relief fitting also extends the service life of the actuator piston o-ring.

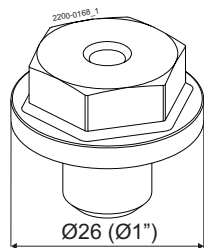

Pos. no. 5

For actuators, manufactured year 2005-2018, with serial number from 1000000 - 5999999 and from 200000000000 - 599999999999 always use steel adapter (pos 5) = 9614065301
Tighten torque = 30 Nm

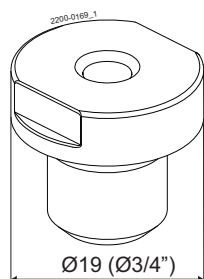

Pos. no. 5

For actuators, manufactured year 2019 --> with serial number from 6000000 to 7000000 and from 600000000000 to 700000000000 always use steel adapter (pos 5) = 9615374701
Tighten torque = 15 Nm

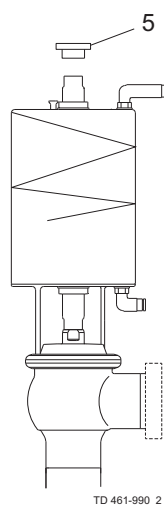

Alfa Laval recommends max. 3 bar support air
Always use the "3 bar air relief fittings" on support air.
Alfa Laval article number = 9611995903

2 Safety

All warnings in the manual are summarised on this page.

Pay special attention to this instructions below so that severe personal injury and/or damage to the valve are avoided.

Installation

Always read the technical data thoroughly (see section 6 Technical data)

Always release compressed air after use

Never touch moving parts if the actuator is supplied with compressed air

Never touch the valve or the pipelines when processing hot liquids or when sterilising

Never dismantle the valve with valve and pipelines under pressure

Never dismantle the valve when it is hot



Operation

Never dismantle the valve with valve and pipelines under pressure

Never dismantle the valve when it is hot

Always read the technical data thoroughly (see section 6 Technical data)

Always release compressed air after use

Never touch the valve or the pipelines when processing hot liquids or when sterilising

Never touch moving parts if the actuator is supplied with compressed air

Always rinse well with clean water after cleaning



Always handle lye and acid with great care



Maintenance

Always read the technical data thoroughly (see section 6 Technical data)

Always release compressed air after use

Never service the valve when it is hot

Never service the valve with valve and pipelines under pressure

Never stick your fingers through the valve ports if the actuator is supplied with compressed air

Never touch moving parts if the actuator is supplied with compressed air

Always use Alfa Laval genuine spare parts



Transportation

Always ensure that compressed air is released

Always ensure that all connections are disconnected before attempting to remove the valve from the installation

Always drain liquid out of valves before transportation

Always use predesigned lifting points if defined

Always ensure sufficient fixing of the valve during transportation - if specially designed packaging material is available, it must be used

The instruction manual is part of the delivery. Study the instructions carefully.
 The items refer to parts list and service kits section.
 The valve is supplied as separate parts as standard (for welding).
 The valve is assembled before delivery, if it is supplied with fittings.

3.1 Unpacking/delivery

Step 1

CAUTION

Alfa Laval cannot be held responsible for incorrect unpacking.

Check the delivery for:

1. Complete valve, shut-off valve or change-over valve.
2. Delivery note.

Step 2

2a

Shut-off valve:

1. Complete actuator.
2. Bonnet (20).
3. Clamp (19).
4. Valve plug (23).
5. Valve body (22).

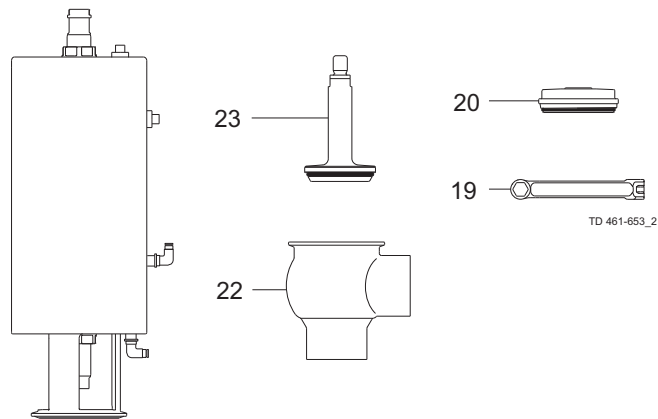

2b

Change-over valve:

1. Complete actuator.
2. Bonnet (20).
3. 2 x clamps (19).
4. Valve plug (27).
5. Lower valve body (22).
6. Valve seat (28).
7. Upper valve body (26).

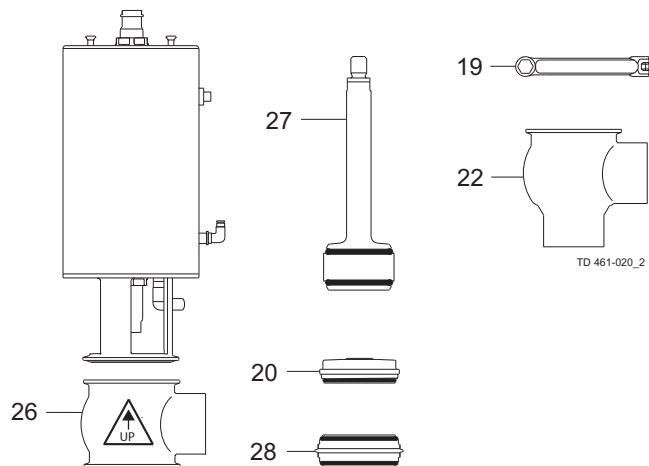

Step 3

Remove possible packing materials from the valve/valve parts.
 Inspect the valve/valve parts for visible transport damage.
 Avoid damaging the valve/valve parts.

3 Installation

Study the instructions carefully and pay special attention to the warnings!
The valve has welding ends as standard but can also be supplied with fittings.

3.2 General installation

Step 1



- **CAUTION**
Alfa Laval cannot be held responsible for incorrect installation.
- **Always** release compressed air after use.
- **Always** read the technical data thoroughly.
See section 6 Technical data.

Step 2



Never touch moving parts if the actuator is supplied with compressed air.

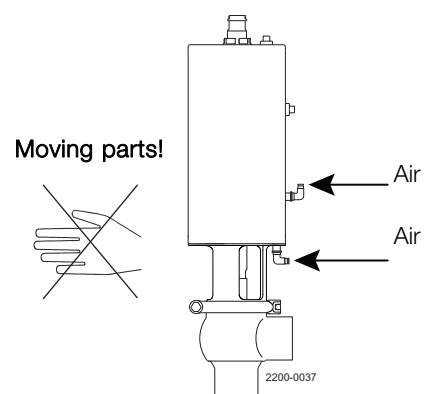

Step 3

To avoid water hammering, it is recommended to install the valve so that the flow is against the spring closing direction.

Shock in the actuator must **never** occur.

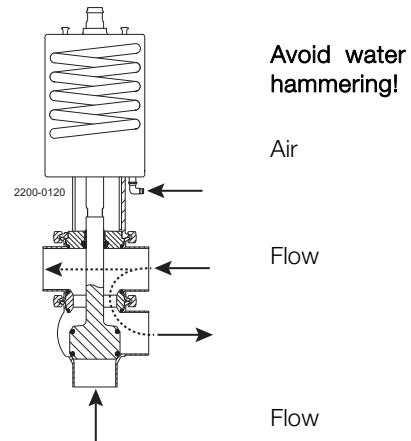

Step 4

Avoid stressing the valve.

Pay special attention to:

- Vibrations.
- Thermal expansion of the pipelines.
- Excessive welding.
- Overloading of the pipelines.

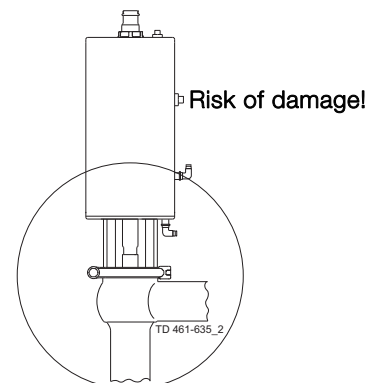

Study the instructions carefully and pay special attention to the warnings!
The valve has welding ends as standard but can also be supplied with fittings.

Step 5

Make sure that the leak detection hole in the valve body:

1. is visible, when mounting the valve vertically
2. always is downwards due to self-draining, when the valve is mounted horizontally.

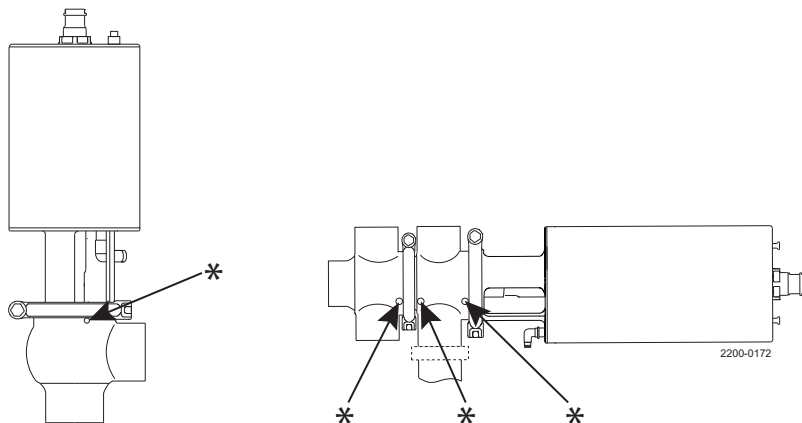

* = Leakage detection hole

3 Installation

Study the instructions carefully.

The valve is supplied as separate parts to facilitate the welding.

The items refer to the parts list and service kits section.

Check the valve for smooth operation after welding.

3.3 Welding

Step 1

Always install valves with more than one valve body so that the seals between the valve bodies can be replaced. Do not weld more than one valve body into the system. It is recommended to fit sufficient clamps/unions to be able to disassemble the valve for servicing.

Valve size	A (mm)	B (mm)
DN40/38 mm	*	740
DN50/51 mm	*	770
DN65/63.5 mm	*	780
DN80/76 mm	*	830
DN100/101.6 mm	*	880

* Depending on body combination and piping solution.

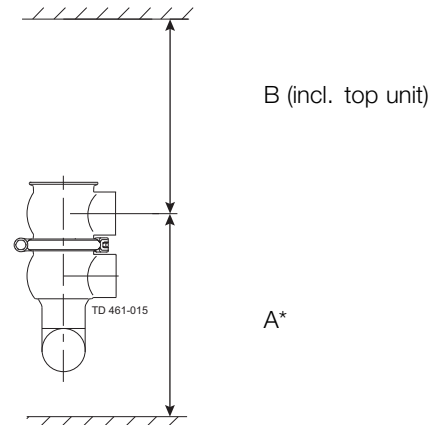

Step 2

Assemble the valve in accordance with the steps on page 28.

Pay special attention to the warnings!

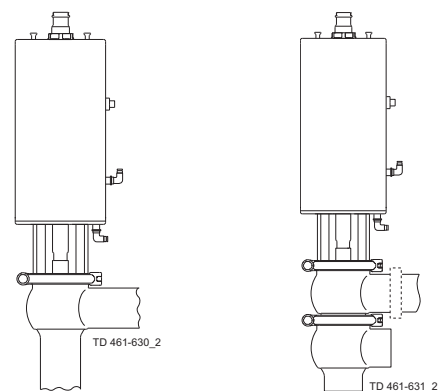

Step 3

Pre-use check:

1. Supply compressed air to the actuator.
2. Open and close the valve several times to ensure that it operates smoothly.

Pay special attention to the warnings!

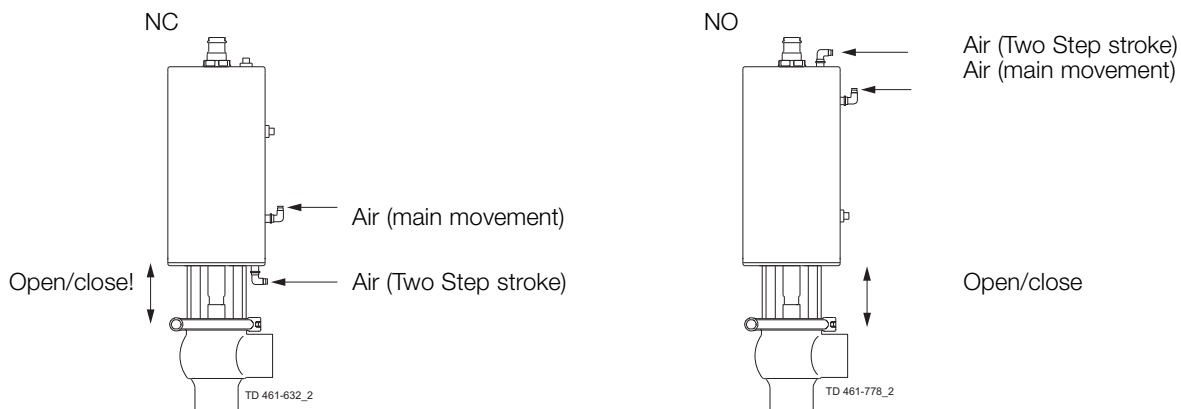

Study the instructions carefully.

The valve is supplied as separate parts to facilitate the welding.

The items refer to the parts list and service kits section.

Check the valve for smooth operation after welding.

3.4 Recycling information

Unpacking

- Packing material consists of wood, plastics, cardboard boxes and in some cases metal straps
- Wood and cardboard boxes can be reused, recycled or used for energy recovery
- Plastics should be recycled or burnt at a licensed waste incineration plant
- Metal straps should be sent for material recycling

Maintenance

- During maintenance, oil and wearing parts in the machine are replaced
- All metal parts should be sent for material recycling
- Worn out or defective electronic parts should be sent to a licensed handler for material recycling
- Oil and all non-metal wearing parts must be disposed of in accordance with local regulations

Scrapping

- At end of use, the equipment must be recycled in accordance with the relevant local regulations. Besides the equipment itself, any hazardous residues from the process liquid must be considered and dealt with in a proper manner. When in doubt, or in the absence of local regulations, please contact your local Alfa Laval sales company. If the actuator is marked with a danger warning, do not attempt to cut the actuator open.
-

4 Operation

Study the instructions carefully.

The item refer to the parts and service kits section.

NO = Normally open (pneumatic movement downwards).

NC = Normally closed (pneumatic movement upwards).

4.1 Description af valve function

The SSV Two step valve has two pistons inside the actuator, which makes it possible to have an intermediate plug position where all body ends are open.

SSV Two step valves are made in a shut-off valve type and a change-over valve type.

Step 1a

Type shut-off valve (only NC)

Two step valves as shut-off (only as NC) can be used for reducing pressure hammers or dosing e.g. in connection with filling of a vessel where an exact volume is required.

The degree of opening for the intermediate position can be adjusted by removing spacer rings inside the actuator (see 5.7 Dismantling of (NC) maintainable actuator).

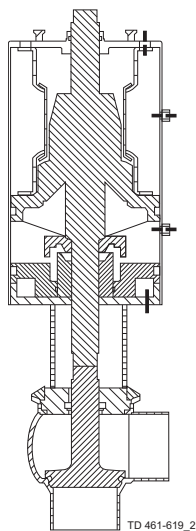

Closed

Throttled position can be adjusted by removing spacers. Plug opening will increase if spacers are removed

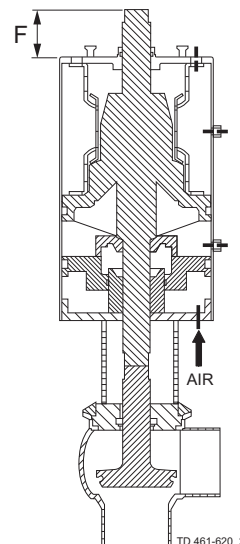

Throttled opening
Two step stroke activated

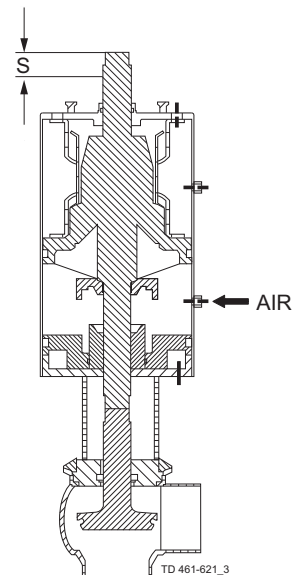

Full open

The plug opening for different shut-off valves and actuator size is shown below.

(Dimensions = mm)	Standard actuator choice (NC)										High pressure actuator (NC)			
	Inch tube					DIN tube					Inch tube		DIN tube	
	38	51	63.5	76.1	101.6	40	50	65	80	100	51	63.5	50	65
F min. Two step stroke (with spacers inside actuator)	3	3	3	2.5	2.5	3	3	3	2.5	2.5	6	6	6	6
F max. Two step stroke (spacers removed inside actuator)	6	11	11	14	14	6	11	11	14	14	9	9	9	9
S = full stroke opening	20	25	25	30	30	20	25	25	30	30	25	25	25	25

Study the instructions carefully.

The item refer to the parts and service kits section.

NO = Normally open (pneumatic movement downwards).

NC = Normally closed (pneumatic movement upwards).

Step 1b

Type change-over valve (NC and NO)

Two step valves as change-over (NC and NO) can be used for drainage of two pipes simultaneously or split of flow in three lines. The valve has a fixed intermediate position and spring return to the end positions.

Spring return to lower position = NC

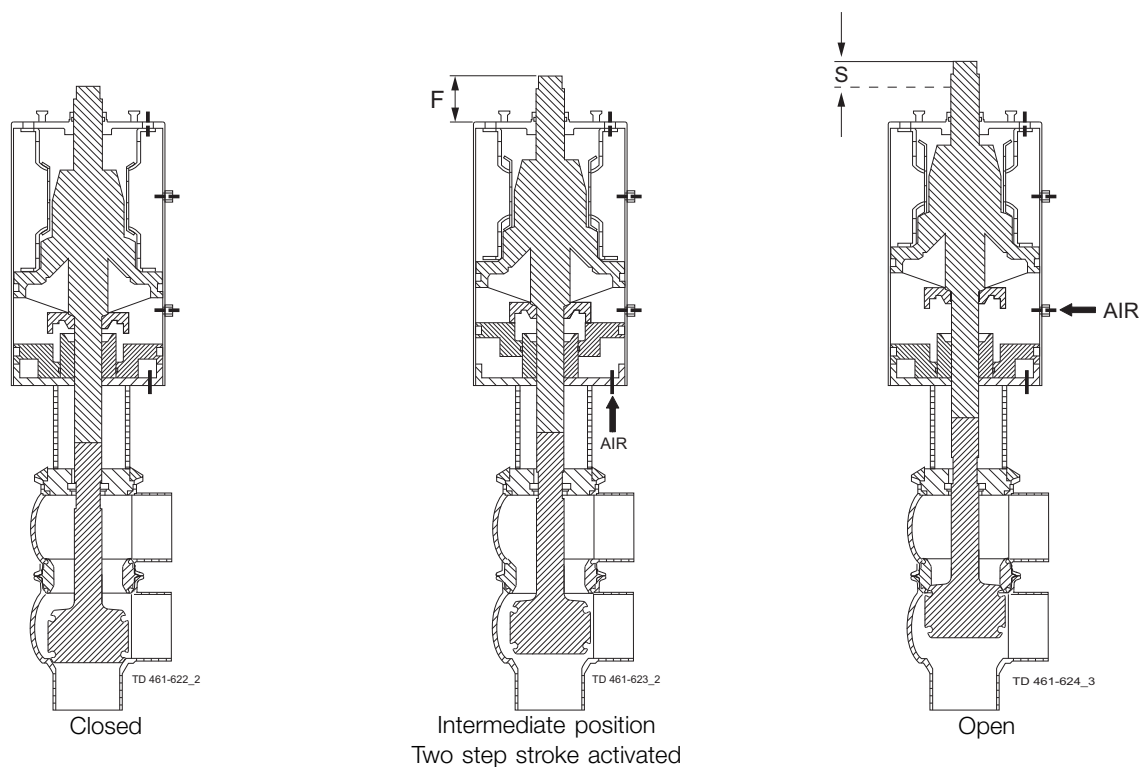

The plug opening for different change-over valves and actuator size is shown below.

(Dimensions = mm)	Standard actuator choice (NC)					High pressure actuator (NC)				
	Inch tube					DIN tube				
	38	51	63.5	76.1	101.6	40	50	65	80	100
F = fixed intermeidate position	6.5	11	11	14	14	6.5	11	11	14	14
S = full stroke opening	17	22	22	27	27	17	22	22	27	27

4 Operation

Study the instructions carefully.

The item refer to the parts and service kits section.

NO = Normally open (pneumatic movement downwards).

NC = Normally closed (pneumatic movement upwards).

Spring return to upper position = NO

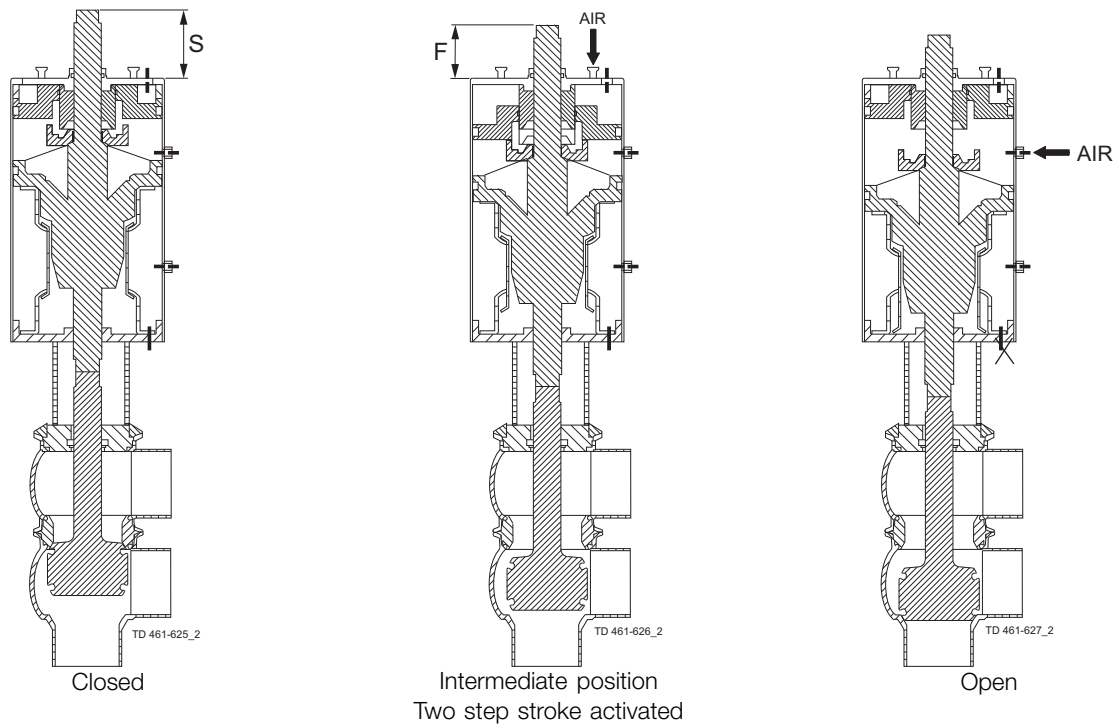

The plug opening for different change-over valves and actuator size is shown below.

Dimensions = mm	Standard actuator choice (NC)										High pressure actuator (NC)			
	Inch tube					DIN tube					Inch tube		DIN tube	
	38	51	63.5	76.1	101.6	40	50	65	80	100	51	63.5	50	65
F = Fixed intermediate position	11	11	11	11	11	11	11	11	11	11	11	11	11	11
S = full stroke opening	17	22	22	27	27	17	22	22	27	27	22	22	22	22

Study the instructions carefully and pay special attention to the warnings!
Ensure that the valve operates smoothly.
The items refer to the parts list and service kits section.

4.2 Operation

Step 1



- **CAUTION**
Alfa Laval cannot be held responsible for incorrect installation.
- **Always** release compressed air after use.
- **Always** read the technical data thoroughly.
See section 6 Technical data.
- **Always** use Alfa Laval genuine spare parts.
The warranty of Alfa Laval products is dependent on use of Alfa Laval genuine spare parts.

Step 2



Never touch the valve or the pipelines when processing hot liquids or when sterilising.

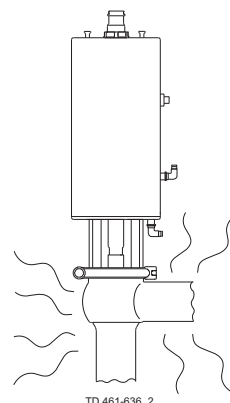

Burn hazard!!

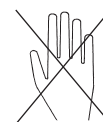

Step 3



Never touch moving parts if the actuator is supplied with compressed air.

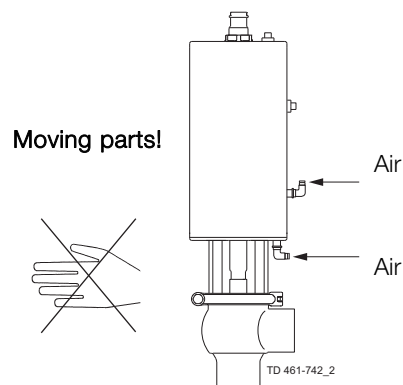

4 Operation

Study the instructions carefully and pay special attention to the warnings!
Ensure that the valve operates smoothly.
The items refer to the parts list and service kits section.

Step 4

Lubrication of valves:

1. Ensure smooth movement between lip seal (A) and plug stem (B).
2. Lubricate the lip seal with Klüber Paraliq GTE 703 if necessary (see page 22).

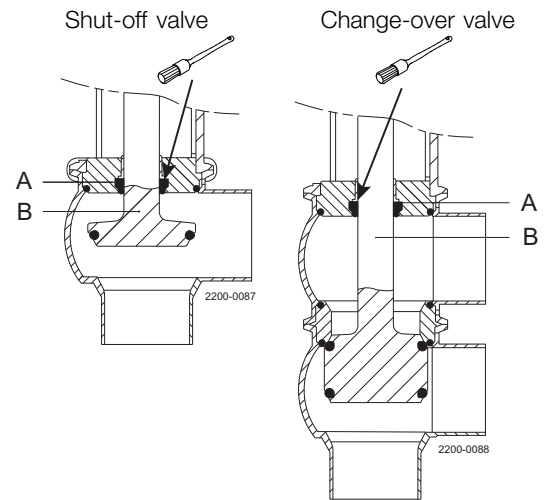

Step 5

Lubrication of actuator

1. Ensure smooth movement of the actuator (the actuator is lubricated before delivery).
2. Lubricate all seals with Molykote Longterm 2 plus if necessary.

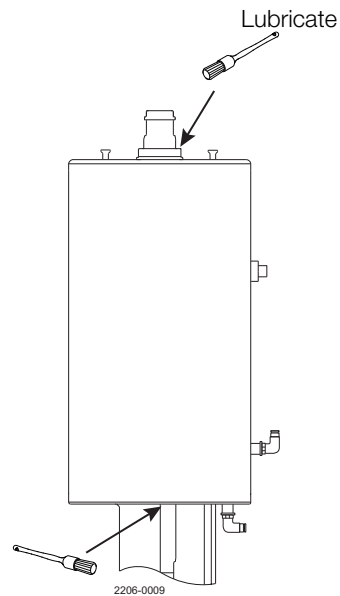

Pay attention to possible faults. Study the instructions carefully.
The items refer to the parts list and service kits section.

4.3 Troubleshooting

NOTE!

Study the maintenance instructions carefully before replacing worn parts - see page 22!

Problem	Cause/result	Repair
External product leakage	Worn or product affected lip seal and/or O-ring	<ul style="list-style-type: none"> - Replace the seals - Replace with seals of a different rubber grade
Internal product leakage	<ul style="list-style-type: none"> - Worn or product affected plug seal - Product deposits on the seat and/or plug - Product pressure exceeds actuator specification 	<ul style="list-style-type: none"> - Replace the seal - Replace with a seal of a different rubber grade - Frequent cleaning - Replace with a high pressure actuator - Use auxiliary air on the spring side (do not exceed 3 bar). Alfa Laval article number = 9611995903. See section 2.3 Safety precautions and section 3.2 General installation, - Reduce product pressure
Water hammering	The flow direction is the same as the closing direction	<ul style="list-style-type: none"> - The flow direction should be against the closing direction. See section 3.2 General installation, Step 3 - Throttle air release of solenoid in top unit
The valve does not open/close	Product pressure exceeds actuator specification	<ul style="list-style-type: none"> - Replace with a high pressure actuator - Reduce product pressure - Use auxiliary air on the spring side. Always use the pressure relief fittings (3 bar) on support side. Alfa Laval article number = 9611995903

If marked with a danger warning, do **NOT** attempt to cut the actuator open, due to spring under load.

4 Operation

The valve is designed for cleaning in place (CIP).

Study the instructions carefully and pay special attention to the warnings!

NaOH = Caustic soda.

HNO₃ = Nitric acid.

4.4 Recommended cleaning

Step 1



Always handle lye and acid with great care.

Caustic danger!



Always use
rubber gloves!



Always use
protective goggles!

Step 2



Never touch the valve or the pipelines when sterilising.

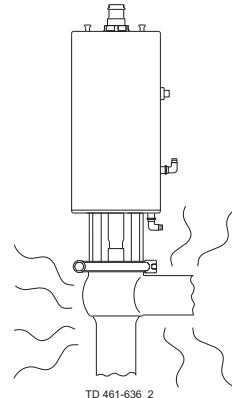

TD 461-636_2

Burn hazard!



Step 3

Clean the plug and the seats correctly.

Pay special attention to the warnings.

Lift and lower valve plug momentarily!

Shut-off valve

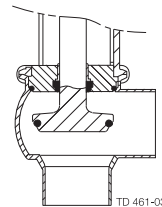

TD 461-031

Change-over valve

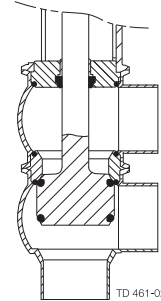

TD 461-029

Step 4

Examples of cleaning agents:

Use clean water, free from chlorides.

1. 1% by weight NaOH at 70° C

1 kg NaOH	+	100 l water	=	Cleaning agent.
2.2 l 33% NaOH	+	100 l water	=	Cleaning agent.

2. 0.5% by weight HNO₃ at 70° C

0.7 l 53% HNO ₃	+	100 l water	=	Cleaning agent.
-------------------------------	---	----------------	---	-----------------

The valve is designed for cleaning in place (CIP).

Study the instructions carefully and pay special attention to the warnings!

NaOH = Caustic soda.

HNO₃ = Nitric acid.

Step 5

1. Avoid excessive concentration of the cleaning agent.
2. Adjust the cleaning flow to the process.
3. **Always** rinse well with clean water after the cleaning.

NOTE

The cleaning agents must be stored/disposed of in accordance with current regulations/directives.

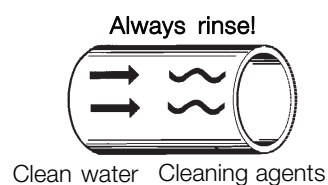

Step 6

NOTE

The cleaning agents must be stored/disposed of in accordance with current regulations/directives.

5 Maintenance

Maintain the valve regularly.

Study the instructions carefully and pay special attention to the warnings!

Always keep spare rubber seals and lip seals in stock.

Check the valve for smooth operation after service.

5.1 General maintenance

Step 1



- CAUTION

- Alfa Laval cannot be held responsible for incorrect installation.
- **Always** release compressed air after use.
- **Always** read the technical data thoroughly.
See section 6 Technical data.
- **Always** use Alfa Laval genuine spare parts.
The warranty of Alfa Laval products is dependent on use of Alfa Laval genuine spare parts.

Step 2



Never service the valve when it is hot.

Never service the valve with valve and pipelines under pressure.

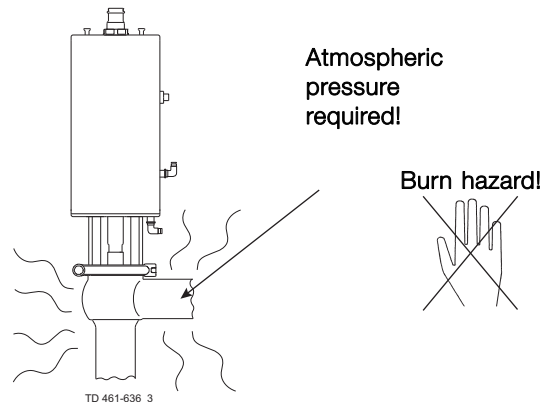

Step 3



Never stick your fingers through the valve ports if the actuator is supplied with compressed air.

Never touch the moving parts if the actuator is supplied with compressed air.

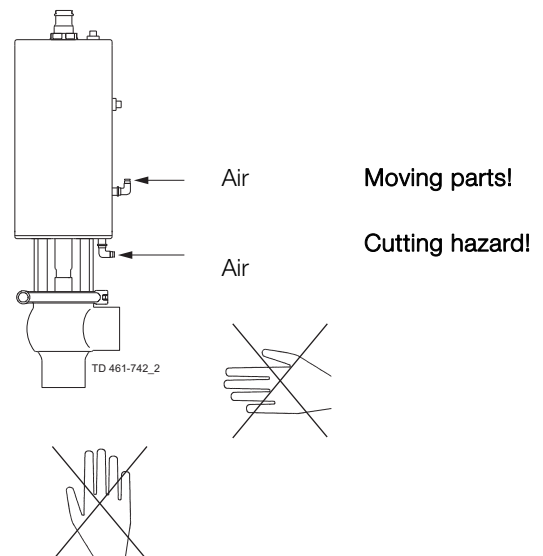

Maintain the valve regularly.
Study the instructions carefully and pay special attention to the warnings!
Always keep spare rubber seals and lip seals in stock.
Check the valve for smooth operation after service.

Below are some guidelines for maintenance and lubrication intervals. Please note that the guidelines are for normal working conditions in one shift.

	Product wetted seals	Actuator bushings complete
Preventive maintenance	Replace after 12 months depending on working conditions	Replace after 5 years depending on working conditions
Maintenance after leakage (leakage normally starts slowly)	Replace at the end of the day	Replace when possible
Planned maintenance	<ul style="list-style-type: none"> - Regular inspection for leakage and smooth operation - Keep a record of the valve - Use the statistics for inspection planning Replace after leakage	<ul style="list-style-type: none"> - Regular inspection for leakage and smooth operation - Keep a record of the actuator - Use the statistics for inspection planning Replace after leakage
Lubrication	Before fitting Klüber Paraliq GTE 703 or similar USDA H1 approved oil/grease	Before fitting Molykote Longterm 2 plus

Pre-use check:

1. Supply compressed air to the actuator.
2. Open and close the valve several times to ensure that it operates smoothly.

Pay special attention to the warnings!

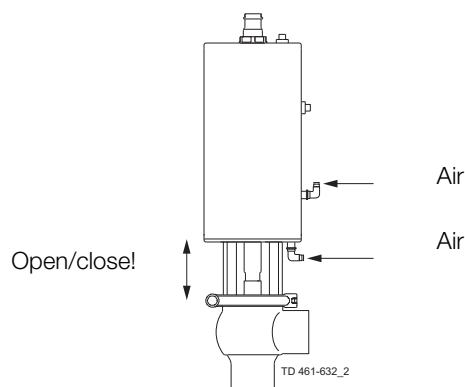

Recommended spare parts

Service kits (see section 7 Parts list and service kits)

5 Maintenance

Study the instructions carefully. The items refer to the parts list and service kits section. Handle scrap correctly.

NC = Normally closed.

NO = Normally open.

5.2 Dismantling the valve

Step 1

1a

Shut-off valve:

1. Supply compressed air to the actuator (only NC).
2. Loosen and remove clamp.
3. Release compressed air (only NC).
4. Lift away the actuator.
5. Unscrew and remove valve plug.
6. Remove O-ring, lip seal and bushing in bonnet.
(Use bushing tool and rubber mallet).

Pay special attention to the warnings!

Note! For plug seal replacement please see page 25.

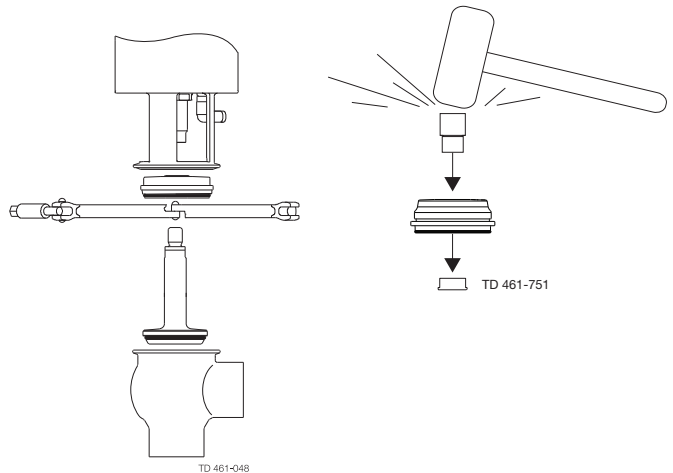

1b

Change-over valve:

1. Supply compressed air to the actuator (only NC).
2. Loosen and remove lower clamp.
3. Release compressed air (only NC).
4. Lift away the actuator and upper valve body.
5. Supply compressed air to the actuator (only NO).
6. Unscrew and remove valve plug.
7. Release compressed air (only NO).
8. Remove seat and O-rings.
9. Loosen and remove upper clamp.
10. Remove upper valve body.
11. Remove O-ring, lip seal and bushing in bonnet.
(Use bushing tool and rubber mallet.
See drawing, step 1a).

Pay special attention to the warnings!

Note! For plug seal replacement please see page 25.

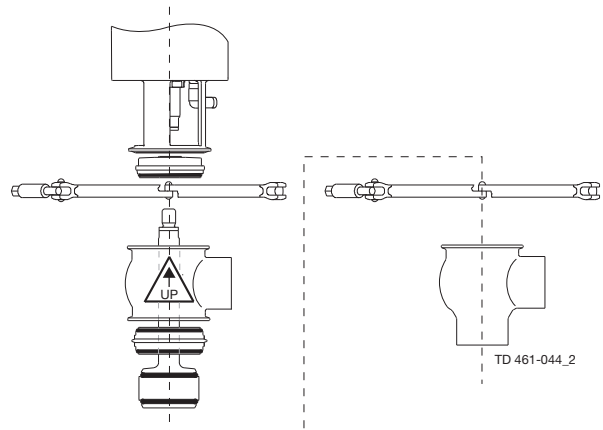

Study the instructions carefully. The items refer to the parts list and service kits section. Handle scrap correctly.

NC = Normally closed.

NO = Normally open.

5.3 Plug seal replacement

Step 1

1. Remove old seal ring using a knife, screwdriver or similar.
Be careful not to damage the plug surface.
If using a screwdriver it must be placed underneath the plug groove (see drawing 1).
2. Grease the new seal ring with Paralique GTE 703, which is included in the service kit.
Only use a very small amount of grease.
3. Fit the seal ring on the plug without pressing it into the groove.
Be careful not to twist the seal ring.
Use a screwdriver (two turns) to fit the seal ring properly and to ensure it is not twisted (see drawing 2).
4. The seal ring can now be mounted by hand or with the Alfa Laval plug tool.

Drawing 1

It is important to place the screwdriver underneath the plug.

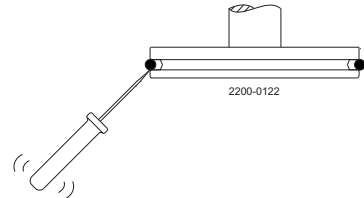

Drawing 2

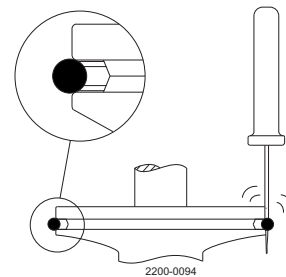

5 Maintenance

Study the instructions carefully. The items refer to the parts list and service kits section. Handle scrap correctly.

NC = Normally closed.

NO = Normally open.

Step 2

Mounting plug seal ring by hand

1. Check the seal ring is premounted as described in step 1.
To ensure correct mounting, press with your thumb on the seal ring, which must be done approximately 10 times and always with opposite pressure points, from A to B, to C and D (see drawing 3).
The rest of the seal ring can now be pressed into the groove so the whole seal ring is mounted. Check that there are NO "bulge" (see drawing 4).
If there is a little bulge – then use the screwdriver to eliminate the bulge.
Again press with the thumb on the seal ring and keep the pressure while rotating 360° (see drawing 3).
2. It is important to release compressed air behind the seal ring.
This is done with a screwdriver and always underneath the plug as shown.
It must be done at one or two different points on the circumference.
Be careful not to make marks on the surface of the plug and seal ring (see drawing 5).

Drawing 3

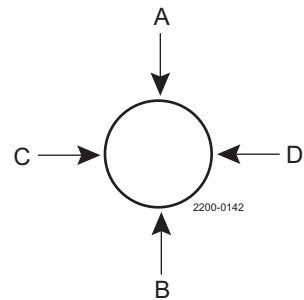

Drawing 4

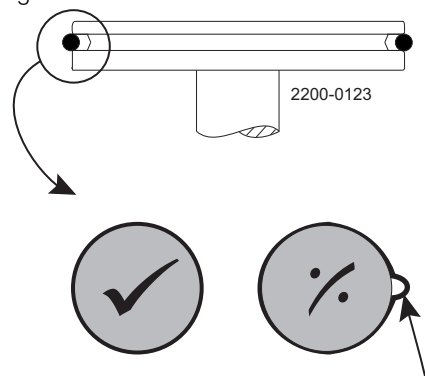

Drawing 5

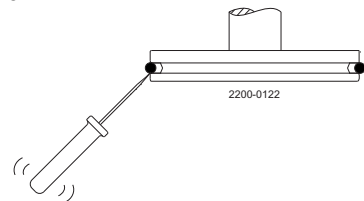

Study the instructions carefully. The items refer to the parts list and service kits section. Handle scrap correctly.

NC = Normally closed.

NO = Normally open.

Step 3

Mounting plug seal ring with Alfa Laval plug seal tool

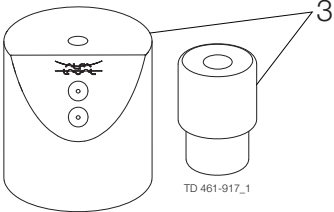
Mounting tool for elastomer plug seals	DN40 38 mm	DN50 - DN65 51 mm - 63.5 mm	DN80 - DN100 76.1 mm - 101.6 mm
	9613172901	9613172902	9613172903

Exhaust holes
for screwdriver

ø20 hole
for plug spindle

1. Part B

"Part B" has a small and a large diameter as the tool can be used for two plug sizes – e.g. plug tool = 9613172902 can be used for DN50/ISO51 (small) and DN65/ISO63 (large).

"Part B" therefore has to be turned so it matches the plug size diameter.

2. Part A

"Part A" has an upper and lower exhaust hole, as the tool can be used for two plug sizes – e.g. plug tool = 9613172902.

The upper exhaust hole is for the small plug size e.g. DN50/ISO51 (small) and the lower exhaust hole is for DN65/ISO63 (large).

When using a "change-over plug" the ø20 spindle must also be fitted in "part A" and "part B" (see drawing 2).

When using a "reverse acting plug" the ø20 spindle must only be fitted in "part A" (see drawing 2).

When using a "standard shut-off plug" the ø20 spindle is only fitted in "part B" (see drawing 1).

3. Fit the plug spindle in "part B" or "part A".

Place "part A" onto "part B" and then press "hard" down on top of "part A".

Now fit the screwdriver into the exhaust hole and underneath the plug groove meanwhile keeping the pressure on "part A". This should ensure correct removal of air behind the seal ring. Normally the sound "Psst" can be heard one time (see drawing 3).

A "drill press" can of course also be used to press down on "part A".

4. It is important to release compressed air behind the seal ring. This is done with a screwdriver and always underneath the plug as shown (see drawing 4).

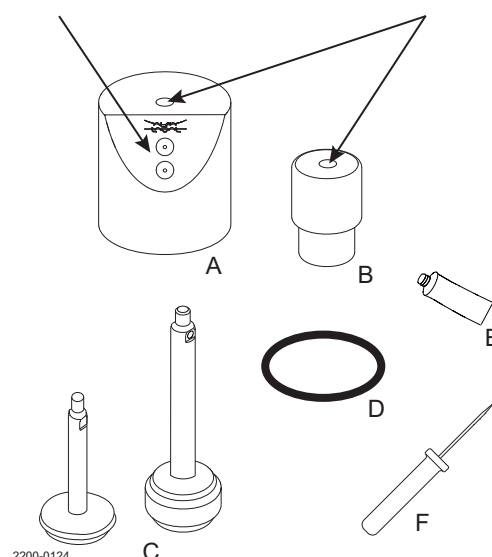

- A. Part A
- B. Part B
- C. Plugs
- D. O-ring
- E. Grease Paralique GTE703 from service kit
- F. Screwdriver (no sharp corner)

5 Maintenance

Study the instructions carefully. The items refer to the parts list and service kits section. Handle scrap correctly.

NC = Normally closed.

NO = Normally open.

Drawing 1

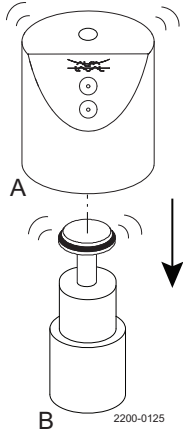

Drawing 2

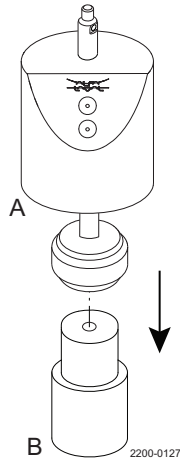

Drawing 3

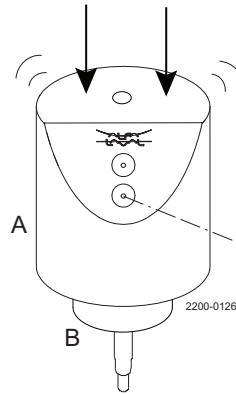

Drawing 4

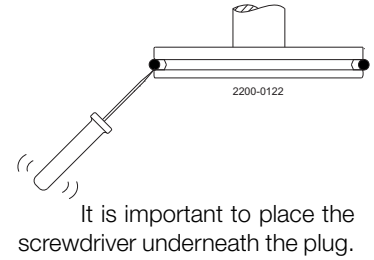

5.4 Valve assembly

Reverse order of 5.2 Dismantling the valve.

Lubricate O-ring (21) and lip seal (25) with Klüber Paraliq GTE 703.

Remember to tighten spindle and plug (use two 17 mm spanners).

- Change-over plug tighten torque = **30 Nm**
- Shut-off plug tighten torque = **20 Nm**

If there are vibrations in the pipeline, Alfa Laval recommends to use Loctite no. 243.

The clamps' thread must be lubricated before tightening - max. torque for the clamps is 10-12 Nm.



Pay special attention to the warnings.

Study the instructions carefully. The items refer to the parts list and service kits section. Handle scrap correctly.

NC = Normally closed.

NO = Normally open.



5.5 Actuator types

Different actuator types for the SSV valve

In June 2016 the below change was implemented and the “removable yoke with bolts” version is thereby phased out and replaced by the “yoke without bolts” version.

NOTE

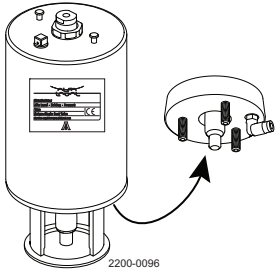
It is important to check for warnings marked on the actuator when servicing an actuator - see below table.

Actuator type	Fully maintainable actuator Spring cage and can be opened	Fully maintainable actuator Spring cage and can be opened
		
Yoke type	“Removable yoke with bolts”. If the yoke with bolts is damaged it has to be replaced by the “yoke without bolts”	“Yoke without bolts”
Service	Yes	Yes
Marked with warnings	No	No
Year of production	From 2006 to June 2016	From June 2016

5 Maintenance

Study the instructions carefully.

The items refer to the parts list and service kits section. Handle scrap correctly.

A/A = Air/air activated.

Service tool: see spare parts.

5.6 Actuator bushing replacement

If the actuator is marked with a danger warning, do **NOT** attempt to cut the actuator open.



Do **NOT** attempt to disassemble the actuator due to spring under load danger!



Do **NOT** attempt to cut the actuator open due to spring under load danger!

Step 1

Introduction

- The actuator service kit contains two bushings and four o-rings.
- Mount the thick O-ring inside and the thin O-ring outside the bushing.
- Always lubricate the spindle and o-rings thoroughly with “Molykote Longterm 2 Plus” before mounting the new bushings.

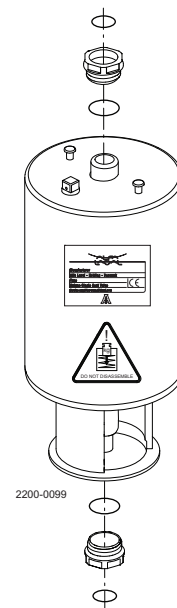

Study the instructions carefully.

The items refer to the parts list and service kits section. Handle scrap correctly.

A/A = Air/air activated.

Service tool: see spare parts.

Step 2

Introduction - Standard socket wrench

Use a 27 mm socket wrench to mount the bushings, as the space in the yoke is limited.

A socket wrench 24x27 (length = 185 mm) is a standard tool, which can be purchased from all tool shops.

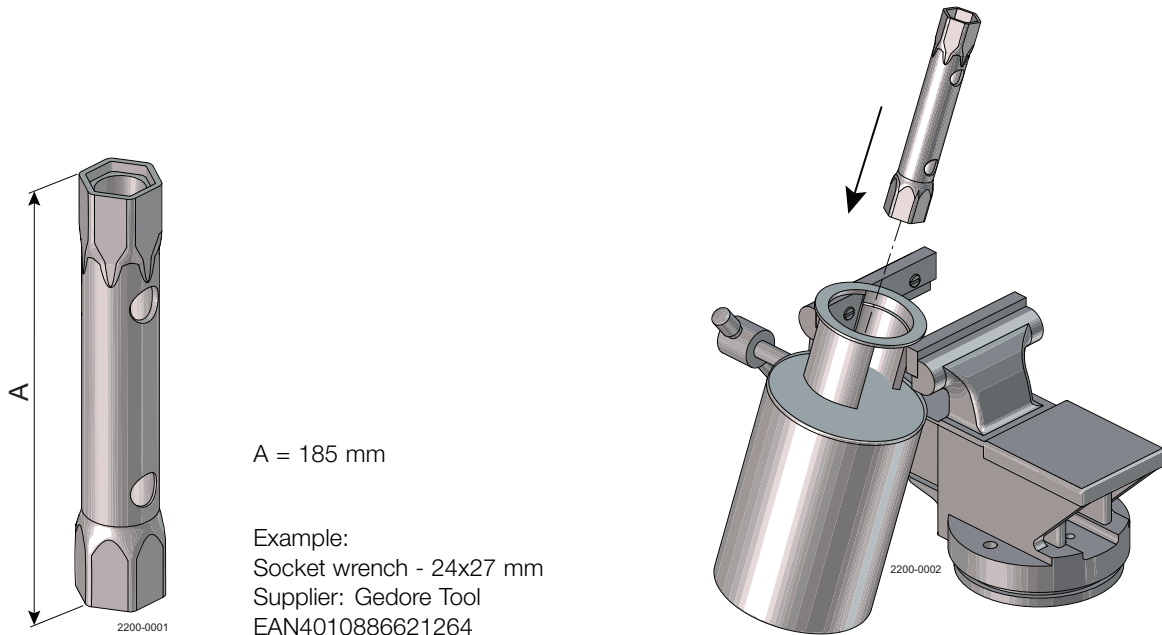

Step 3

Introduction - Aligning spindle

The actuator spindle can in some cases be forced off centre by the internal spring, see drawing below.

In these cases, the alignment spindle shown below, together with the socket wrench, is a great help and ensures a reliable mounting of the bushing. The spindle can either be purchased from Alfa Laval together with the socket wrench (**9614198401**) or it can be manufactured locally using the below dimensions.

Spindle forced off centre by spring inside actuator

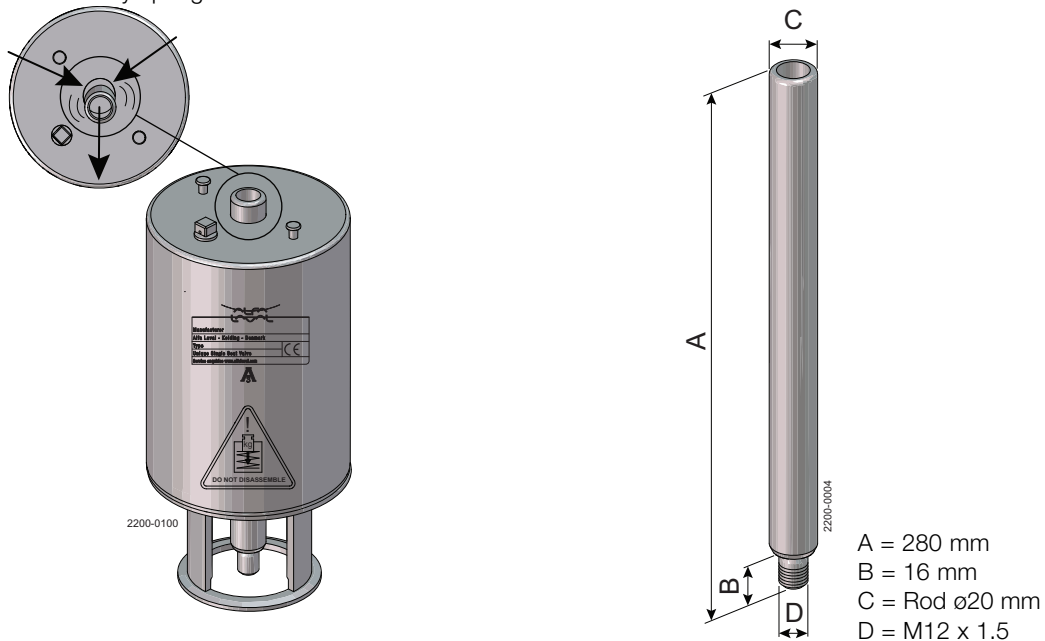

5 Maintenance

Study the instructions carefully.

The items refer to the parts list and service kits section. Handle scrap correctly.

A/A = Air/air activated.

Service tool: see spare parts.

Step 4

The actuator must be carefully fixed in a vice if it is dismantled from the valve. Be careful not to press the yoke flange oval when fixing the actuator in the vice. Only fix carefully on the “yoke leg” as shown below.

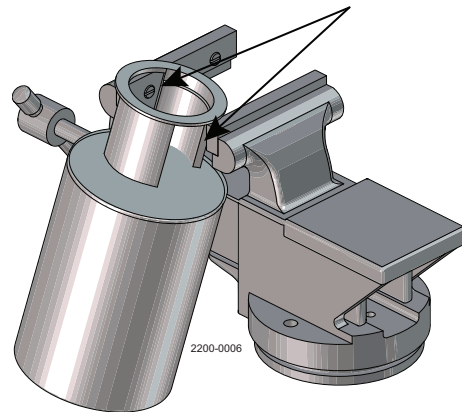
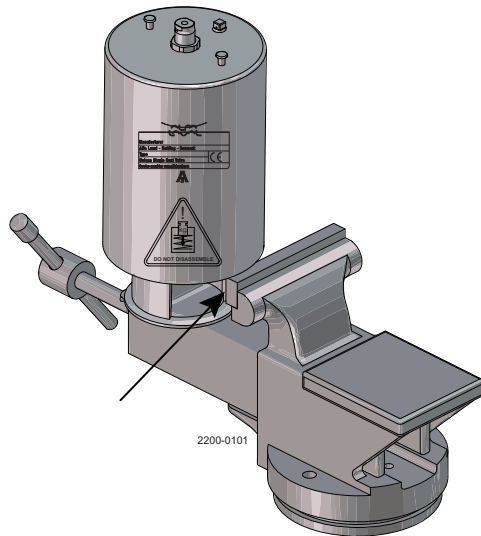

Step 5

Remove adapter screw.

(After spindle alignment the adapter screw has to be remounted.)

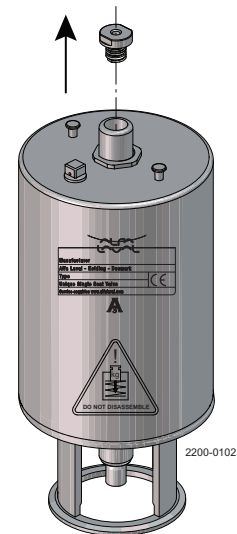

Step 6

1. Lubricate thoroughly both the actuator spindle and o-rings.
2. Grease with “Molykote Longterm 2 plus”.
3. Fit the **bushing** on the spindle.

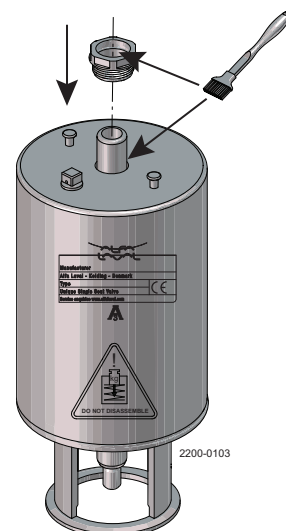

Study the instructions carefully.

The items refer to the parts list and service kits section. Handle scrap correctly.

A/A = Air/air activated.

Service tool: see spare parts.

Step 7

Fit the aligning spindle to the actuator spindle, and then mount the socket wrench.

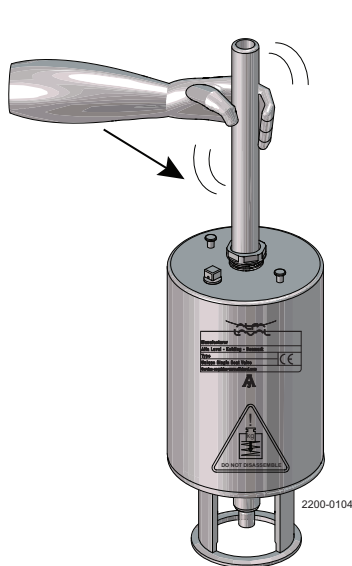

Aligning spindle

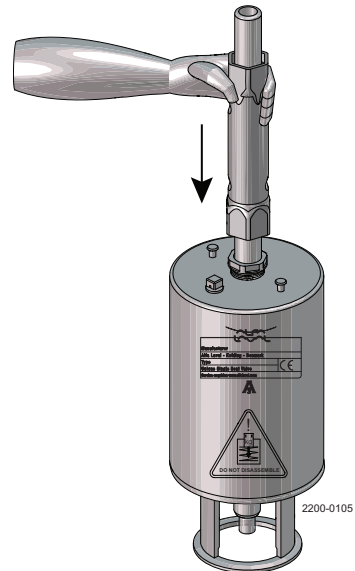

Socket wrench

Step 8

Now pull the aligning spindle to centre the actuator spindle. In this position rotate the **bushing** 180° backwards and then begin to fasten the bushing. Make sure that the thread catches evenly!

The bushing must only be tightened with a torque of 10 Nm (7 lb-ft) which can be done by turning "hard" by hand.

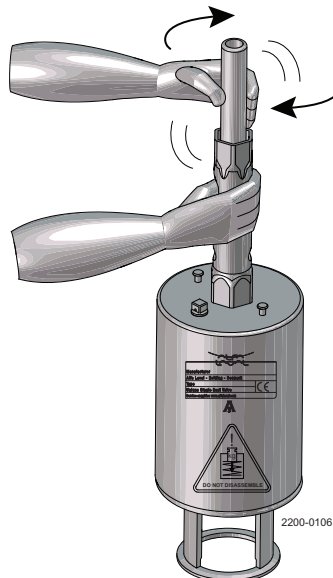

5 Maintenance

Study the instructions carefully.

The items refer to the parts list and service kits section.

5.7 Dismantling of (NC) maintainable actuator

Changing of wear parts

1. Rotate cylinder (1).
2. Remove lock wire (10) and pull away cylinder (1). This can be done by careful using air on fitting (12).
3. Remove O-ring (11) from bottom (15).
4. Unscrew top bushing (6) and remove o-ring (8).
5. Remove piston (2) together with support disk (16), thrust plate (53) and O-ring (3).
6. Remove spring assembly (14).
7. Remove seegering lock ring (57) using a seegering-tang tool.
8. Remove piston (52) and O-rings (3+60) together with spacer rings (56).
Spacer rings (56) are only mounted on sht-off valve and not on chnge-over valve.
Spacer rings are used to reduce the piston (52) stroke, so that the sht-off valves intermediate plug position can be adjusted.
9. Remove guide ring (58) and O-ring (7).
10. Guide (54) is screwed on bottom part (15) and should only be dismantled if guide (54) is broken.
If guide (54) has to be dismantled start with unscrewing nuts (18) and remove yoke (13) and loosen nut (55). With a special tool it now is possible to dismantle guide (54). This is shown in chapter 5.10 Changing pneumatic movement on fully maintainable actuator (NC/NO), Step 2.

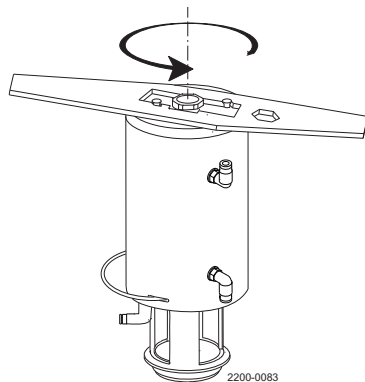

Rotate cylinder with service tool!

Study the instructions carefully.
The items refer to the parts list and service kits section.

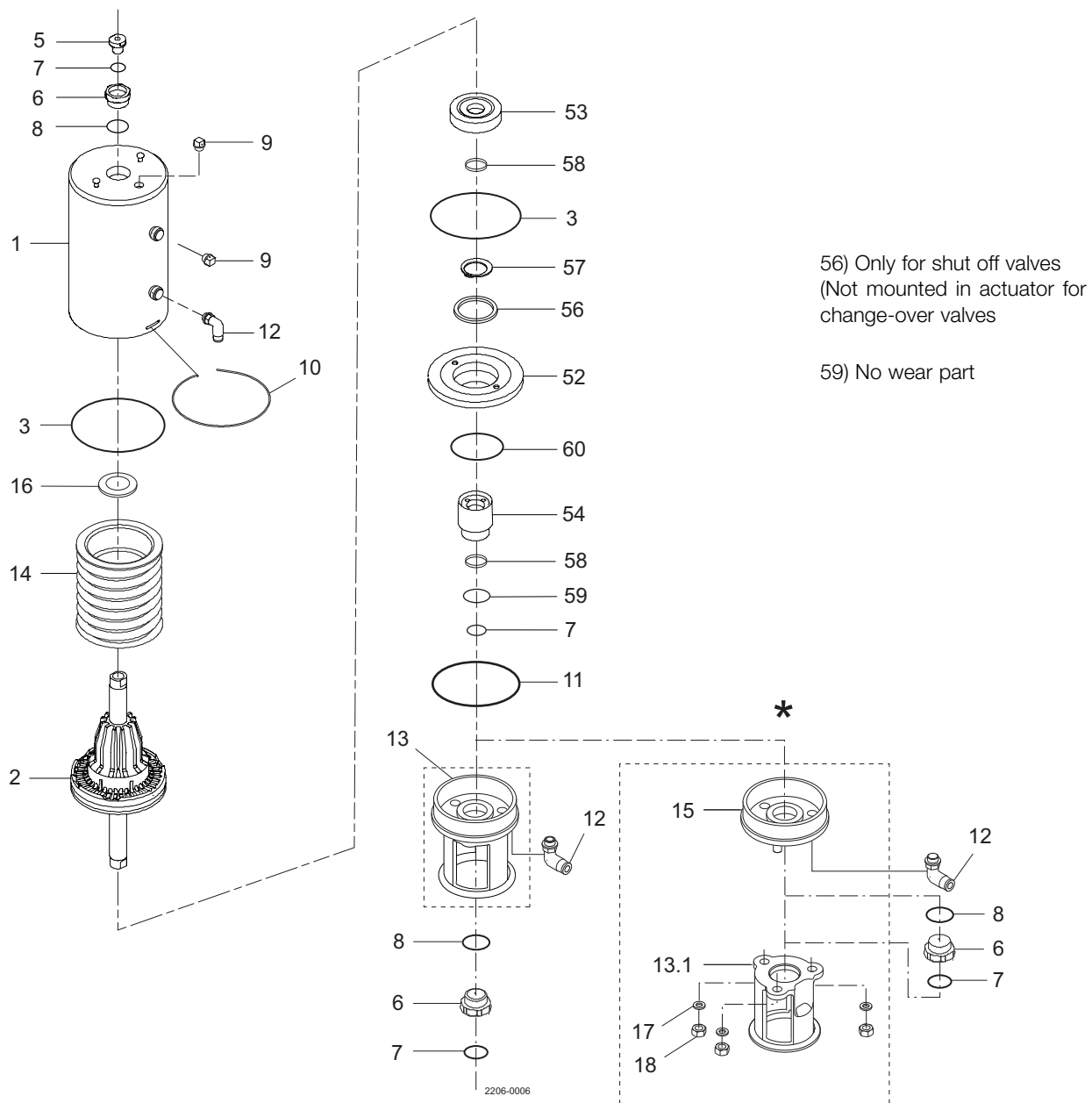

5 Maintenance

Study the instructions carefully.

The items refer to the parts list and service kits section.

5.8 Dismantling of change-over (NO) maintainable actuator

Changing of wear parts

1. Rotate cylinder (1).
2. Remove lock wire (10) and pull away cylinder (1). This can be done by careful using air on fitting (12).
3. Remove O-ring (11) from bottom (15).
4. Remove piston (2) together with support disk (16), thrust plate (53) and O-ring (3) .
5. Remove spring assembly (14).
6. Unscrew nuts (18) and remove yoke (13).
7. Unscrew bottom bushing (6) and remove O-ring (8).
8. Remove seegering lock ring (57) using a seegering-tang tool.
9. Push piston (52) out of cylinder (1) using air on fitting (12) and remove O-rings (3+60) together with spacer ring (56).
Spacer ring (56) are only mounted on GR.3 actuator (diameter = $\varnothing 154$) type normally open.
10. Remove guide ring (58) and O-ring (7).
11. Guide (54) is screwed on top of cylinder (1) and should only be dismantled if guide (54) is broken.
If guide (54) has to be dismantled loosen nut (55). With a special tool it now is possible to dismantle guide (54).
This is shown in chapter 5.10 Changing pneumatic movement on fully maintainable actuator (NC/NO), Step 2.

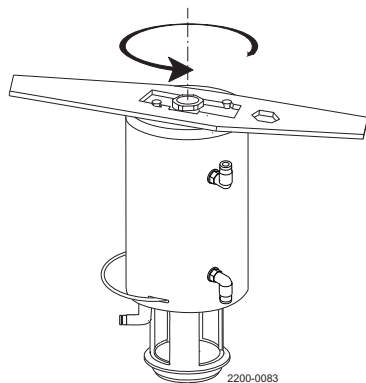

Rotate cylinder with service tool!

Study the instructions carefully.
The items refer to the parts list and service kits section.

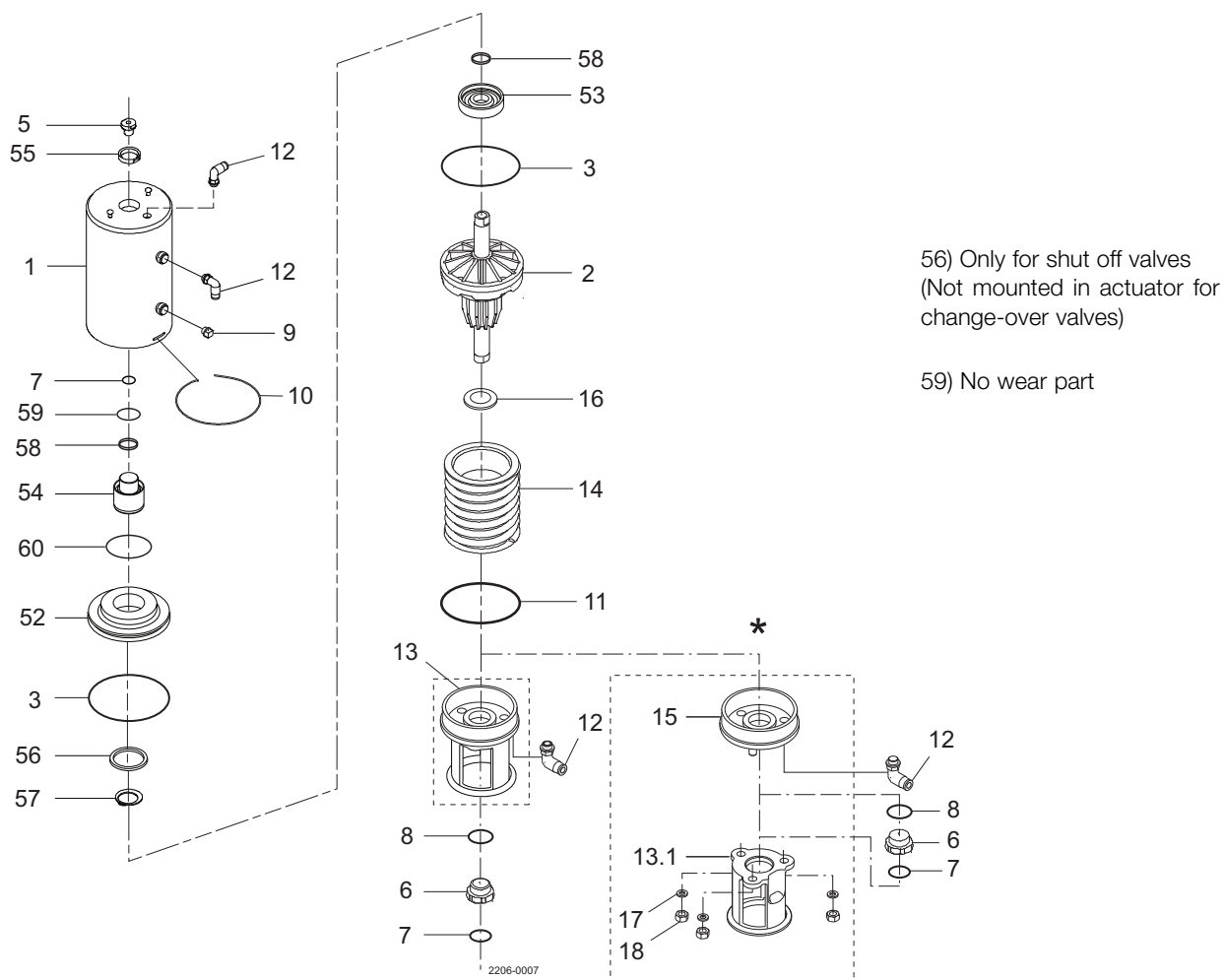

5.9 Assembly of maintainable actuator

Reverse order of 5.7. (Dismantling of (NC) maintainable actuator).
Reverse order of 5.8. (Dismantling of (NO) maintainable actuator).

5 Maintenance

Study the instructions carefully.

The items refer to the parts list and service kits section.

5.10 Changing pneumatic movement on fully maintainable actuator (NC/NO)

Before dismantling check that the actuator not is marked with a warning.

1. Rotate cylinder.
2. Remove lock wire and pull away cylinder.
3. Reverse piston and spring assembly.
4. Reverse adapter, air fitting and plug to opposite end.
5. Reassemble in reverse order (3 to 1).

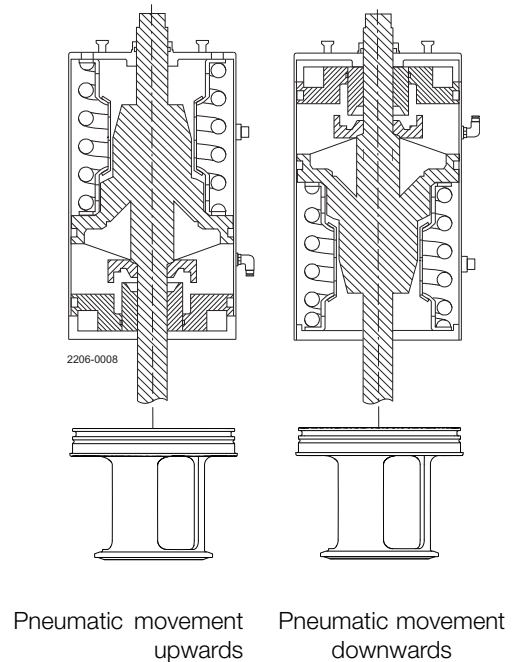

Step 1

Actuator for the shut-off valves can not be reversed as it only is possible to operate in NC position.

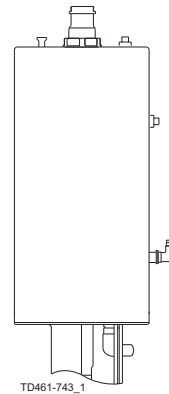

Actuator for the change-over valves can be reversed from NC to NO and from NO to NC.
(see section 5.7 Dismantling of (NC) maintainable actuator and 5.8 Dismantling of change-over (NO) maintainable actuator)

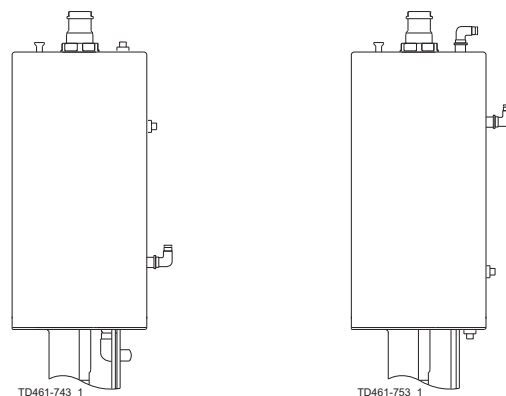

Study the instructions carefully.

The items refer to the parts list and service kits section.

Step 2

Reversing maintable actuator operation can be done by reversing parts inside the actuator. It is necessary to use a special "SSV Two step guide tool" (see Step 3) and a "turning tool" (item no. 3135302191) for mounting the guide (54).

1. Fit the "SSV Two step guide tool" in a vice.
2. Fit O-ring (59) in guide (54) and by hand screw it in cylinder (1).
3. Fit "turning tool" on top of cylinder (1) and tighten (torque 15 - 20 Nm).

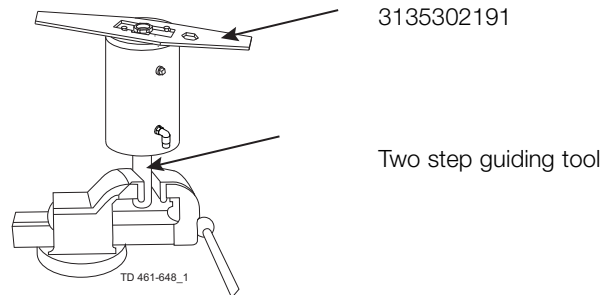

Step 3

Drawing of "SSV Two step mounting tool"

1. Use $\varnothing 32$ mm bar and drill two $\varnothing 4$ holes in a diameter $\varnothing 26$ mm.
(The depth of $\varnothing 4$ holes should be approx 6 mm)
2. Edges on $\varnothing 32$ bar has to be min. R0.5 so it can fit into guide (54).
3. Use $\varnothing 4$ mm bar with a length of approx 10 mm.
4. Apply loctite 270 or 638 and fit the two $\varnothing 4$ pins so length are according to drawing.

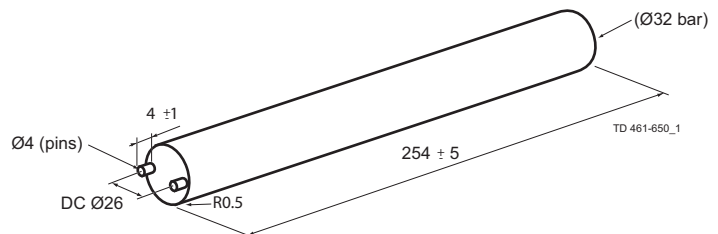

6 Technical data

*It is important to observe the technical data during installation, operation and maintenance.
Inform all personnel about the technical data.*

6.1 Technical data

principle The valve is a pneumatic seat valve in a hygienic and modular design remote-controlled by means of compressed air. It has few and simple moveable parts which results in a very reliable valve and low maintenance cost.

Standard design The Unique SSV Two Step valve comes in a one or two body configuration. With its module built structure it is designed for flexibility and easy customization through the electronic configurator.

Data - valve/actuator	
Max. product pressure	1000 kPa (10 bar).
Min. product pressure	Full vacuum (depending on product specifications).
Temperature range	-10° C to + 140° C (standard EPDM seal).
Air pressure, actuator	500 to 700 kPa (5 to 7 bar).
Materials - valve/actuator	
Product wetted steel parts	1.4404 (316L) (internal Ra < 0.8 µm).
Other steel parts	1.4301 (304).
Plug seal	EPDM / PTFE (TR2).
Other product wetted seals	EPDM (standard).
Optional product wetted seals	HNBR and FPM.
Other seals	NBR.

Weight (kg)

Nominal size	Inch tubes DN/OD					DIN tubes DN					High Pressure			
											Inch tubes DN/OD		DIN tubes DN	
	38	51	63.5	76.1	101.6	40	50	65	80	100	51	63.5	50	65
Shut-off	7	7.3	8.3	14.4	16.7	7	7.3	8.3	14.9	16.7	8.6	9.6	8.6	9.6
Change-over valve	8	8.9	10.3	17	21	8.2	8.9	10.5	17.9	21	10.2	11.6	10.2	11.6

Noise

One metre away from and 1.6 metres above the exhaust the noise level of a valve actuator will be approximately 77db (A) without noise damper and approximately 72 db (A) with damper - measured at 7 bar air-pressure.

7 Parts list and service kits

The drawing shows Unique Single Seat Valve - Two Step.
The items refer to the parts list in the following sections

7.1 Drawing

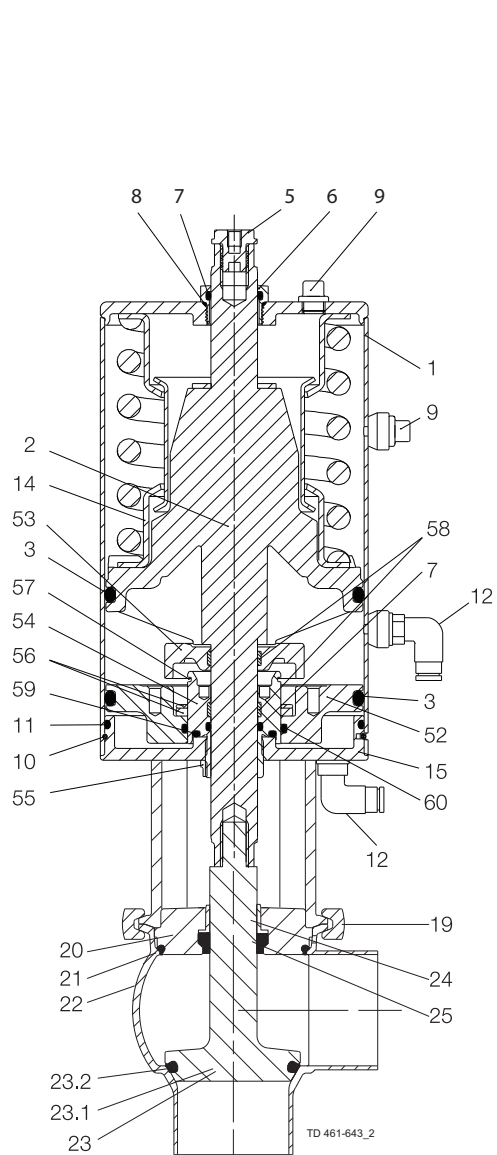

Shut-off valve

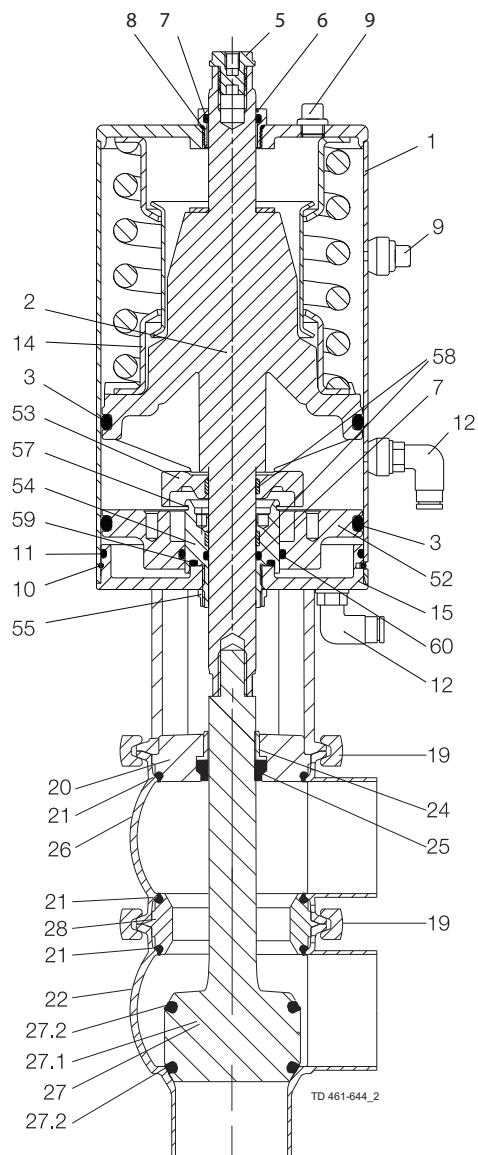

Change-over valve

The drawing shows Unique Single Seat Valve - Two Step.
The items refer to the parts list in the following sections

7.2 Unique Single Seat Valve - Two Step 38-101.6mm - shut-off valve

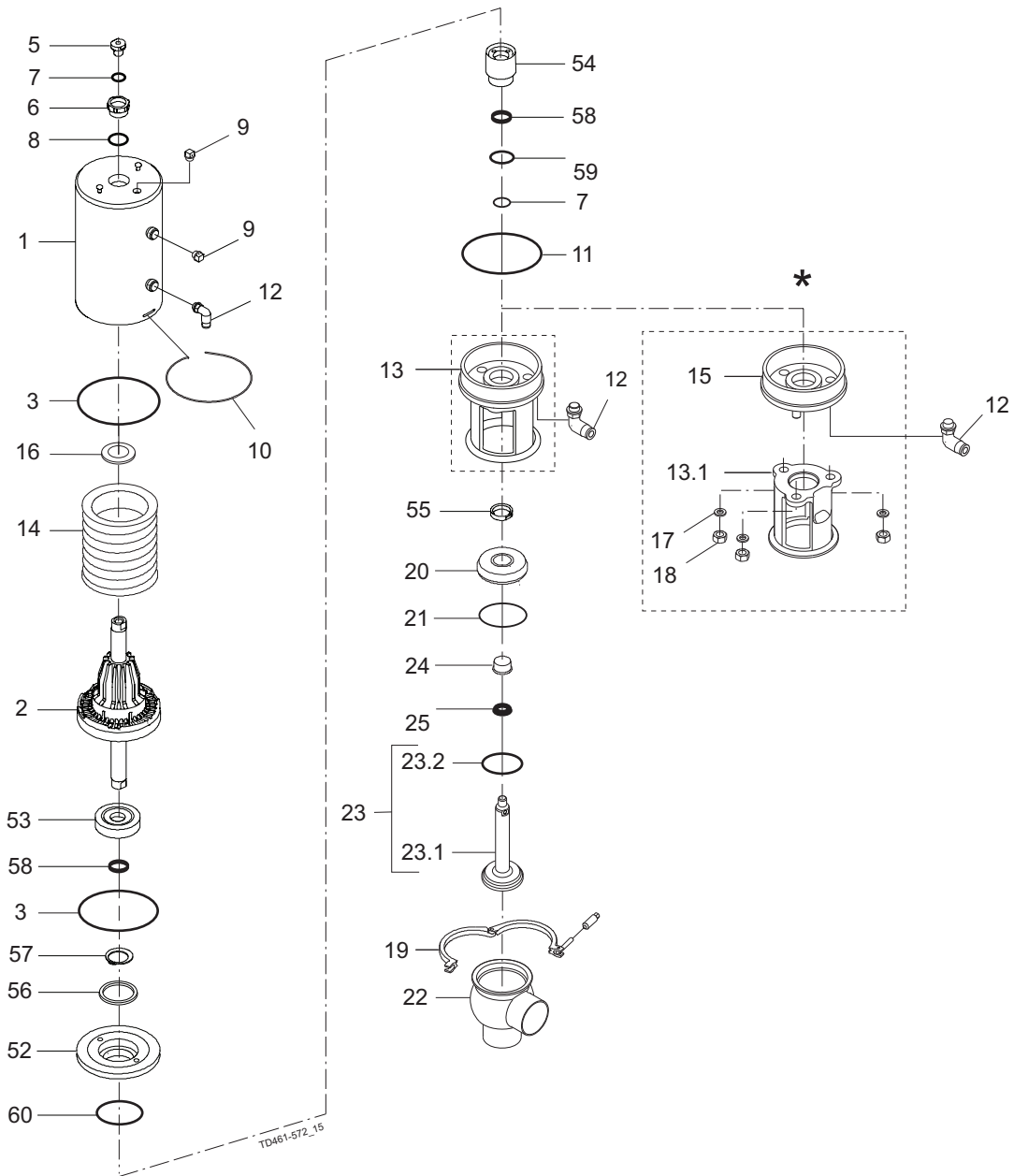

*) "Remove yoke with bolts" version, produced from 2006 to June 2016.
Replaced by "yoke without bolts" (13)

7 Parts list and service kits

The drawing shows Unique Single Seat Valve - Two Step.
The items refer to the parts list in the following sections

Parts list

Pos.	Qty	Denomination
1	1	Cylinder
2	1	Piston
3 □	2	O-ring
5	1	Adapter
6 □	1	Bushing
7 □	2	O-ring
8 □	1	O-ring
9	2	Plug
10	1	Lock wire
11 □	1	O-ring
12	2	Air fitting
13	1	Yoke without bolts (0616 -)
13.1	1	Yoke (- 0616)
14	1	Spring assembly
15	1	Bottom (- 0616)
16 □	1	Support disc
17	3	Washer (- 0616)
18	3	Nut (- 0616)
19	1	Clamp
20	1	Bonnet
21 ♦	1	O-ring
22	1	Valve body, lower
23	1	Plug, shut off
23.1	1	Plug, shut off
23.2 ♦	1	Plug seal
24	1	Bushing
25 ♦	1	Lip seal
52	1	Piston
53	1	Thrust plate
54	1	Guide
55	1	Nut
56	2	Spacer
57	1	Lock ring
58	2	Guide ring
59 □	1	O-ring
60 □	1	O-ring

Service kits

Denomination	DN 40 38 mm	DN 50 51 mm	DN 65 63.5 mm	DN 80 76 mm	DN 100 101.6 mm
Service kits for actuator					
□ Service kit, actuator	9611926738	9611926738	9611926738	9611926739	9611926739
Service kit for product wetted parts					
Service kit, EPDM	9611926502	9611926503	9611926504	9611926505	9611926506
Service kit, HNBR	9611926508	9611926509	9611926510	9611926511	9611926512
Service kit, FPM	9611926514	9611926515	9611926516	9611926517	9611926518

Parts marked with □ are included in the service kits (actuator)

Parts marked with ♦ are included in the service kits (product wetted parts)

Tool for bushing (pos. 24) 9613160901

TD900-467/5

The drawing shows Unique Single Seat Valve - Two Step.
The items refer to the parts list in the following sections

7.3 Unique Single Seat Valve - Two Step 38-101,6mm - change-over valve

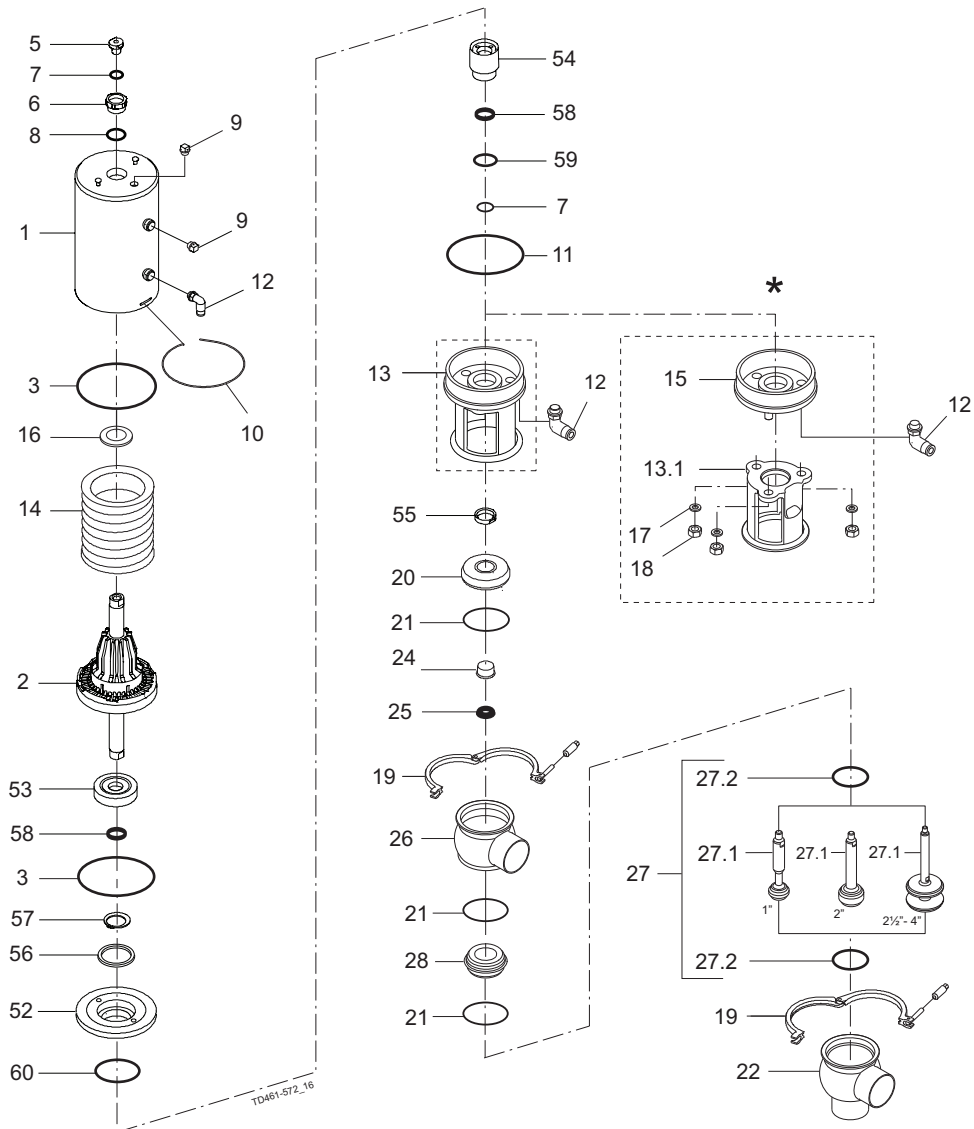

*) "Remove yoke with bolts" version, produced from 2006 to June 2016.
Replaced by "yoke without bolts" (13)

7 Parts list and service kits

The drawing shows Unique Single Seat Valve - Two Step.
The items refer to the parts list in the following sections

Parts list

Pos.	Qty	Denomination
1		Actuator
	1	Cylinder
2	1	Piston
3 □	2	O-ring
5	1	Adapter
6 □	1	Bushing
7 □	2	O-ring
8 □	1	O-ring
9	2	Plug
10	1	Lock wire
11 □	1	O-ring
12	2	Air fitting
13	1	Yoke without bolts
13.1	1	Yoke
14	1	Spring assembly
15	1	Bottom
16 □	1	Support disc
17	3	Washer
18	3	Nut
19	2	Clamp
20	1	Bonnet
21 ♦	3	O-ring
22	1	Valve body, lower
24	1	Bushing
25 ♦	1	Lip seal
26	1	Valve body, upper
27	1	Plug, change over, ISO complete
27.1	1	Plug, change over
27.2 ♦	2	Plug seal
52	1	Piston
53	1	Thrust plate
54	1	Guide
55	1	Nut
56	2	Spacer (only for shut-off valve)
57	1	Lock ring
58	2	Guide ring
59 □	1	O-ring
60 □	1	O-ring

Service kits

Denomination	DN 40 38 mm	DN 50 51 mm	DN 65 63.5 mm	DN 80 76 mm	DN 100 101.6 mm
Recommended spare parts: Service kits.					
□ Service kit, actuator	9611926738	9611926738	9611926738	9611926739	9611926739
Service kit for product wetted parts					
Service kit, EPDM	9611926580	9611926581	9611926582	9611926583	9611926584
Service kit, HNBR	9611926586	9611926587	9611926588	9611926589	9611926590
Service kit, FPM	9611926592	9611926593	9611926594	9611926595	9611926596

*The drawing shows Unique Single Seat Valve - Two Step.
The items refer to the parts list in the following sections*

7.4 Mounting tool - Unique SSV - Two Step maintainable actuator

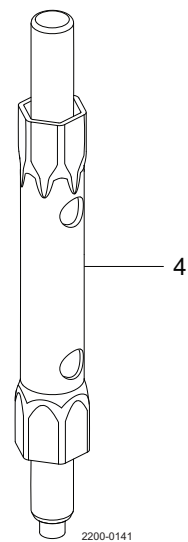
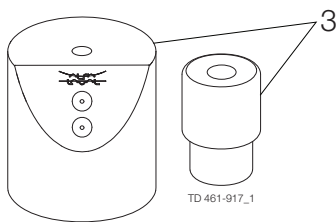
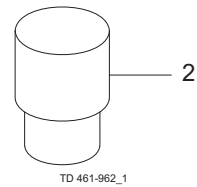
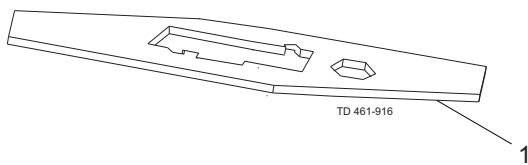

7 Parts list and service kits

*The drawing shows Unique Single Seat Valve - Two Step.
The items refer to the parts list in the following sections*

Parts list

Pos.	Qty	Denomination
1	1	Service tool only for maintainable actuator
2	1	Tool for bushing (pos. 24)
3	1	Mounting tool for elastomer plug seals
4	1	Tool for actuator bushing (pos. 6)
101	1	Lifting tool complete
103	1	Clip

How to contact Alfa Laval

Contact details for all countries are continually updated on our website.

Please visit www.alfalaval.com to access the information directly.

© Alfa Laval Corporate AB

This document and its contents is owned by Alfa Laval Corporate AB and protected by laws governing intellectual property and thereto related rights. It is the responsibility of the user of this document to comply with all applicable intellectual property laws. Without limiting any rights related to this document, no part of this document may be copied, reproduced or transmitted in any form or by any means (electronic, mechanical, photocopying, recording, or otherwise), or for any purpose, without the expressed permission of Alfa Laval Corporate AB. Alfa Laval Corporate AB will enforce its rights related to this document to the fullest extent of the law, including the seeking of criminal prosecution.